

# STATIONARY CLAMPING DEVICES

## Mandrel actuating units ms dock / hs dock

### Actuating unit hs dock. Technical data and order overview

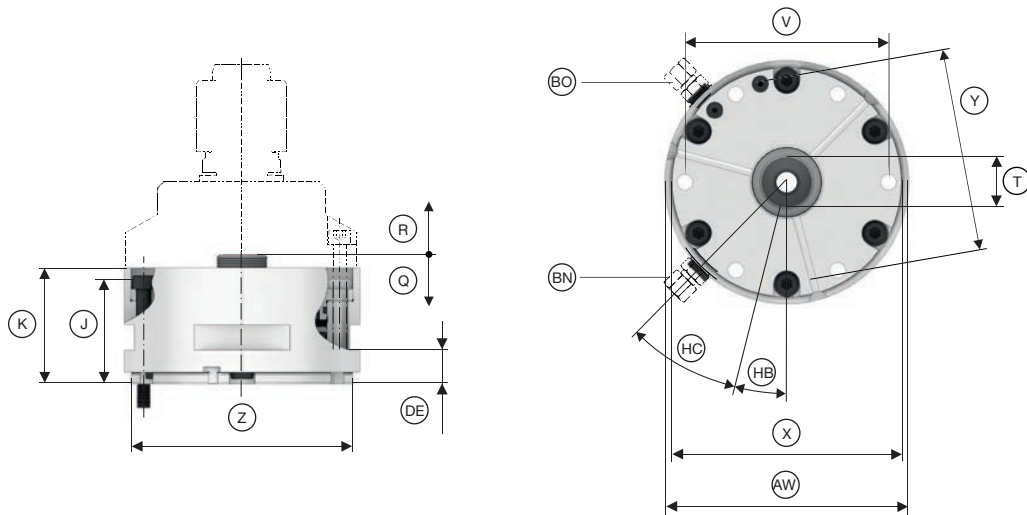

Product	hs dock			
Size	XXS - 4 / A - F		5 - 7	
Variant	Without spring	With spring	Without spring	With spring
Max. axial drawtube force [pull / push] [kN]	35		45	
Max. actuating pressure [bar]	56	44	51	47
Max. release pressure [bar]	56		51	
Spring draw force axial [kN]		4		4
Spring release pressure [bar]		12		8
Reserve stroke axial [mm] Q	3,5	1,5	3,5	1,5
Release stroke axial [mm] R	4	2	4	2
Interface X	Ø 131 H6		Ø 219 H6	
Interface hole circle Y	LK Ø 116 [6 x M8]		LK Ø 192 [6 x M10]	
Connecting thread outside T			M30 x 1,5	
Height [mm] J			62	
Overall height [mm] K	68,5		76	
Outer Ø [mm] AW	139		230	
Bolt hole circle V	LK Ø 116 [6 x M8]		LK Ø 192 [6 x M10]	
Centering edge [mm] Z	131		219	
Clamping edge height [mm] DE			20	
Release BN			[1/8"]	
Clamping BO			[1/8"]	
Release via base plate [°] HC	30		33	
Clamping via base plate [°] HB	15		13,5	
Weight [kg]	9		18	
In stock	✓	-	-	-
Order no.	3023/0001	3023/0002	3023/0003	3023/0004



#### Scope of delivery

- Mandrel actuating unit